

# morphy richards®



Register online for your 2 year guarantee. See back of this instruction book for details.  
(UK and Ireland customers only)  
[www.morphyrichards.co.uk](http://www.morphyrichards.co.uk)

reducing with  
the Carbon Trust



We have committed to  
reduce the carbon footprint  
of this product

[carbon-label.com](http://carbon-label.com)

At Morphy Richards we understand we have an important part to play in helping to care for the environment. That's why we've been working in partnership with the Carbon Trust to measure the carbon footprint of our irons. The footprint calculates the CO2 emitted during the irons life, which includes manufacture, consumer use and disposal.

Visit [www.morphyrichards.co.uk](http://www.morphyrichards.co.uk) to find out the carbon footprint of your iron, as well as tips on how to reduce the carbon footprint of your ironing.

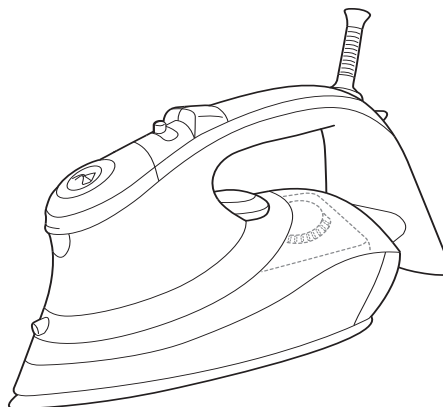

## ComfiGrip iron steam/spray/shot/press



Please read and keep these instructions

### Getting the best from your new iron....

#### Safety first

Caution must be used when handling this appliance as it does get very hot. Always switch off the unit and allow to cool before cleaning or storing.

#### Water system

Do not store the product with water in the tank as water may leak from the soleplate if you forget to turn the steam setting to the off position.



**To improve the life of your new product and to ensure the cleanliness of your clothes, we strongly recommend the use of distilled or demineralised water.**



RN40854 MUK Rev 1

**If you have a problem or complaint, please call our dedicated UK based helpline before returning your product to the retailer from where it was purchased.**



UK Helpline: 0844 871 0960  
Replacement Parts: 0844 873 0726  
Ireland Helpline: 1800 409 119



For details of other Morphy Richards products, plus replacement parts and accessories, please see our website:

[www.morphyrichards.com](http://www.morphyrichards.com)

## **IMPORTANT SAFETY INSTRUCTIONS**

The use of any electrical appliance requires the following common sense safety rules:

Primarily there is danger of injury or death and secondly the danger of damage to the appliance. These are indicated in the text by the following two conventions:

**WARNING: Danger to the person!**

**IMPORTANT:** Damage to the appliance!

In addition, we offer the following safety advice.

### **Location**

- Do not use outdoors or near water.
- The iron must be used and rested on a stable surface.

### **Children**

- Close supervision is necessary when any appliance is used near children.
- Children do not understand the dangers associated with operating electrical appliances.
- Children should be supervised to ensure that they do not play with this appliance.

### **Personal Safety**

- **WARNING: Burns can occur from touching hot metal parts, hot water or steam. Use caution when you turn a steam iron upside down, there may be hot water in the water tank.**
- **WARNING: To protect against the risk of electric shock, do not put the appliance in water or in any other liquid.**
- Do not use the vertical steam feature on clothes that are being worn.
- Never allow the mains lead to over hang the work surface.
- The socket should always be off before plugging or unplugging from the socket. Never yank the cord to disconnect from the socket, instead, grasp the plug and pull to disconnect.
- Do not allow the cord to touch hot surfaces.
- Let the iron cool completely before putting away. Loop the cord loosely around the iron before storing.
- The iron must not be left unattended while it is connected to the supply mains.
- When placing the iron on its heel, ensure that the surface on which the heel is placed is stable.
- This appliance is not intended for use by persons (including children) with reduced physical, sensory or mental capabilities, or lack of experience or knowledge, unless they have been given supervision or instruction concerning use of the appliance by a person responsible for their safety.

### **Other safety considerations**

- Use the iron only for its intended use.
- Always disconnect the iron from the electrical socket when filling with water or emptying, and when not in use.
- If the supply cord is damaged, it must be replaced by the manufacturer, its service agent or similarly qualified person(s) in order to avoid a hazard.
- Do not operate the iron with a damaged cord, or if the iron has been dropped or damaged and if there are visible signs of damage, or if it is leaking. To avoid the risk of electric shock, do not disassemble the iron, but telephone Morphy Richards for advice. Incorrect reassembly can cause a risk of electric shock when the iron is used.

### **Special instructions**

If your iron does not work, check the following points:

- Has the temperature control been set to the required temperature? Is the plug in its socket? Is the plug itself or the socket faulty? (Check by plugging in another appliance).
- **WARNING: When not in use, your iron should never be placed flat and left on an ironing board.**
- To prevent damage to the textile being ironed, follow the temperature guide carefully. (Test the inside of the hem of the garment).

- When ironing is complete, remove the plug from the socket, empty any remaining water from the tank, and allow to cool before storage.
- If you drop or severely knock your iron, this could cause internal damage even if the outside appears alright. Have it checked by a qualified electrician.
- It is recommended that you use up one tank full of water by operating your iron's steam and shot of steam functions before ironing any clothes, as some dripping may occur while your iron's steam system is activated.

## **ELECTRICAL REQUIREMENTS**

Check that the voltage on the rating plate of your appliance corresponds with your house electricity supply which must be A.C. (Alternating Current).

If the socket outlets in your home are not suitable for the plug supplied with this appliance, the plug should be removed and the appropriate one fitted.

**WARNING: A damaged or severed mains cable fitted with a plug should never be connected to the mains supply. It must be destroyed, as a damaged cable becomes hazardous if connected to a power socket.**





Should the fuse in the 13 amp plug require changing, a 13 amp BS1362 fuse must be fitted.

**WARNING: This appliance must be earthed.**

## **INSTRUCTIONS FOR USE**

### **Temperature guide**

Heat setting markings on the adjustable control dial of all Morphy Richards irons match those of the International Textile Care Labelling Code.

Symbol		 (120°C Max) Cool	 (160°C Max) Warm	 (210°C Max) Hot	'Max' Setting
Control knob positions	Do not iron at all	●	●●	●●●	
Fabric		Silk, Nylon, Acetates e.g. Acrilan Courtelle, Orlon Triacetates, e.g. Tricel/Polyester	Wool, Polyester mixtures e.g. Polyester/Cotton	Cotton, Linen Rayon, Rayon mixtures, e.g. Rayon/Linen	
Ironing		Iron on wrong side, if moisture required use damp cloth (Not Acetate)		Fabrics requiring this setting usually require steam pressing for heavy cotton, denim etc.	
With water in tank				← Steam/spray/shot of steam →	
		←	Dry and spray	→	
Without water in tank		←	Dry ironing	→	

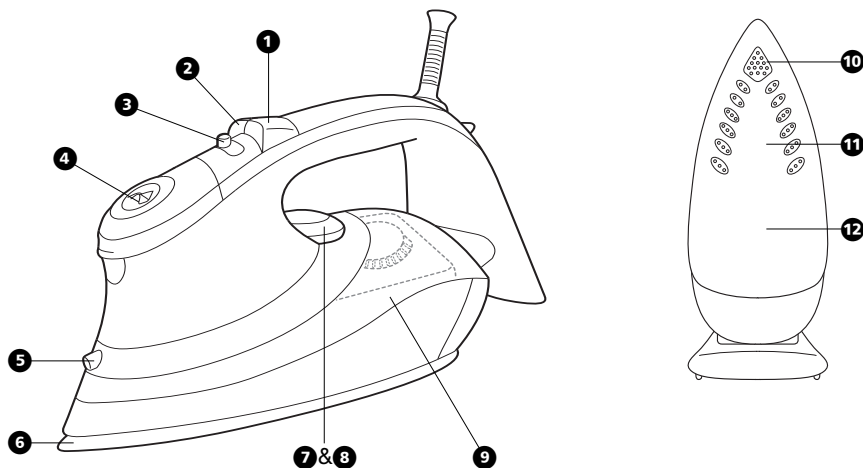

### COMPONENTS OF YOUR IRON

- ❶ Water spray button
- ❷ Steam boost button
- ❸ Steam switch
- ❹ Filling hole with cap
- ❺ Spray nozzle
- ❻ Soleplate
- ❼ Temperature dial
- ❽ Temperature indicator light
- ❾ Water tank

#### Tri-zone Soleplate

- ❿ **Turbo Boost**  
Powerful boost of steam gets into the trickiest of places
- ⓫ **Constant Steam**  
Removes all creases at a level you control
- ⓬ **Press Plate**  
Removes moisture - to set a crease-free finish

### BEFORE USE

Sort out the items to be ironed according to the type of fabric. This will minimise the frequency of temperature adjustment for different garments.

Note: The steam facility should only be used on garments which are suitable for ironing within the steam range (see the 'Temperature guide' on page 3, which shows the steam range).

Textiles and clothes are supposed to carry ironing instructions. If they don't, you should follow the fabric guide on page 3, but be sure to test the temperature by ironing the hem of the garment or similar discreet area first.

If you turn the control dial down from a hot setting to a cooler setting, wait until the iron temperature has stabilised before you continue ironing.

Delicate fabrics such as silk, wool, velour, etc, are best ironed with an ironing cloth to prevent shine marks.

## FILLING **A**

- 1 Make sure that the iron is not plugged in, then set the steam dial **3** to 'O' position **D** before filling the iron with water.
- 2 Lift the filler cap **4** until it locks and holds in the open position. Fill water through the filling hole into the water tank **9**, using a suitable container **A**.

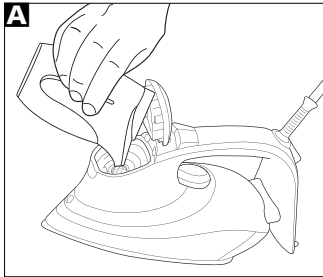

The tank holds 350ml of water. The iron is fitted with a clear view water tank, so you can easily see the water level when filling. During filling, tilt the iron forward to read the water level. The 'MAX' mark is printed on the side of the clear view tank **B**.

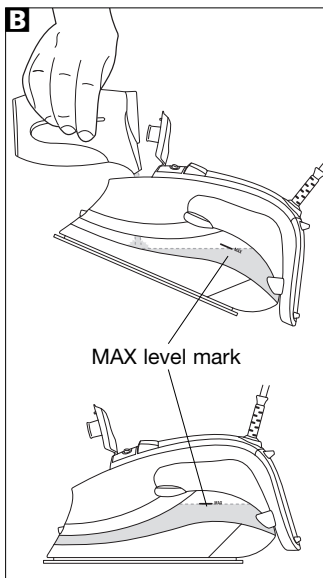

After filling, push the filler cap forward until it clicks in place.

**IN HARD WATER AREAS, THE USE OF DISTILLED OR DEMINERALISED WATER IS RECOMMENDED.**

**Never use battery topping up fluid or water containing any substances like starch, or sugar, or defrosted water from a refrigerator.**

- 3 Always pour out the remaining water after use.

**WARNING: When filling your iron with tap water, always use a suitable container. Never fill directly under the tap.**

## TEMPERATURE CONTROL **C**



- 1 Plug in the iron and switch on the power at the mains socket.
  - 2 Set the temperature dial **7** to the temperature required **C**, but don't start ironing immediately. If you wait a few minutes, the iron will stabilise at the required setting.
- Your Morphy Richards iron is fitted with a temperature indicator light **8** which will switch on and off whilst you are ironing. This is perfectly normal as it shows that the iron is maintaining the heat setting you have chosen.
  - It is always a good idea to begin with cool fabrics and work up to higher settings. An iron heats up quicker than it cools down so you will save time and energy.

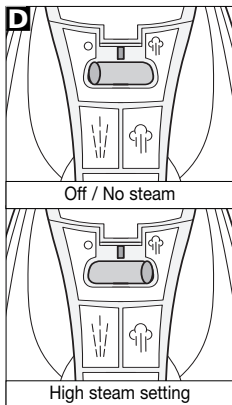

## FEATURES OF YOUR IRON

### Dry ironing

You can use your iron as a dry iron only. Make sure the variable steam control **3** is set to the 'O' symbol **D**.

Any temperature setting may be used depending on the garment. The spray feature may be used, provided there is water in the tank (see 'Filling' section). You do not need to put any water in the tank when dry ironing only.

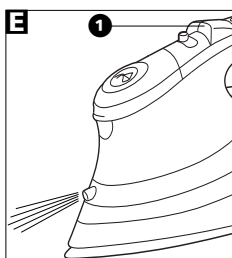

### Water Spray

Press the spray button **1** and aim the spray of water at stubborn creases. You can do this whilst dry ironing providing there is water in the tank. When using the water spray it may be necessary to push the button a few times to get the spray pump primed.

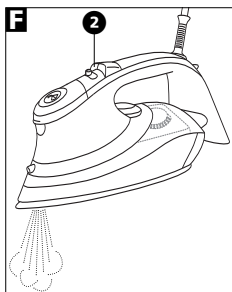

### Variable steam

Fill the iron with water as described in 'Filling', page 5, and insert the plug into the electrical socket.

The steam output can be varied from low to high by moving the variable steam control. When using the iron at the bottom of the steam range (see steam range shown on page 4), the steam output should be adjusted to the low setting.

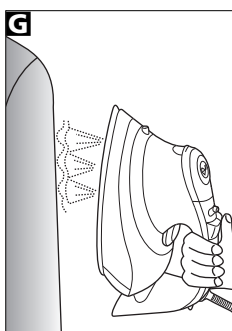

The steam facility should only be used on garments which are suitable for ironing within the steam range.

### Steam boost

Press the steam boost button **2** to obtain a boost of extra steam for ironing out creases in heavy material such as denim etc.



The shot of steam can be used whilst dry ironing, providing there is water in the tank, and the temperature control is set within the steam range.

Do not use shot of steam at temperatures below the steam range shown on the control dial.

Note: For optimum steam quality, do not operate the shot more than three times in succession.

### Vertical steam

Hold the iron in a vertical position between 1cm and 2cm away from the item **G**. Press the steam boost button **2**, this will create vertical steam. This feature is especially useful for removing creases from hanging clothes, curtains, wall hangings, etc.

Note: For optimum steam quality, do not operate the shot more than three times in succession.

### Water system

Do not store the product with water in the tank as water may leak from the soleplate **6** if you forget to turn the steam setting to the off position.

Remember to only turn the steam selector switch **3** to steam when the control dial is set to a temperature within the steam range.

Remember: the lower the temperature setting, the lower the steam setting.

**Life long anti-scale system** (certain models only)

The life long anti-scale system reduces scale deposits and helps prolong the life of the iron.

**MAINTENANCE**

**To clean a ceramic coated soleplate**

(certain models only)

In the unlikely event of any man-made fibre fusing to the soleplate, set the iron at the 3-dot position and pass it over a clean piece of cotton which will draw the deposit off the surface.

Do not use scouring powder or solution as this could cause damage to the coating.

**IMPORTANT: Do not descale the soleplate with descaling products, proprietary cleaning agents or vinegar when flushing out the soleplate.**

**To clean a stainless steel soleplate**

(certain models only)

To keep the soleplate of your iron clean and free of limescale, we recommend that you use one of the gentle chrome, silver or stainless steel cleaners that are generally available. Always follow the manufacturer's instructions.

To clean off melted man-made fibres, set the iron at the 3 dot position and pass it over a clean piece of cotton which will draw the deposit off the surface.

**IMPORTANT: Do not descale the soleplate with descaling products, proprietary cleaning agents or vinegar when flushing out the soleplate.**

**To clean the exterior**

Allow the iron to cool and wipe over with a damp cloth and mild detergent, then wipe with a dry cloth.

**Emptying and storing**

When you have finished ironing, unplug your iron. Ensure that the variable steam control is set at the 'O' position **1**, lift up the filler cap and empty any remaining water out of the filling hole **2**. Do not store in the box, but in an upright position, so that any drops of water remaining cannot leak out and discolour the soleplate.

**IMPORTANT:** The flex can be damaged if wound too tightly around the iron after use. Make a loose loop with the flex and wrap it around the iron. The iron must be cool before winding the flex and storing on its heel **3**.

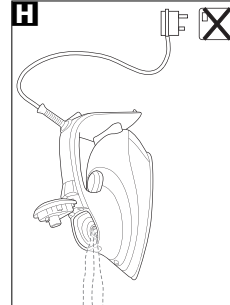

**HELPLINE**

If you have any difficulty with your appliance, do not hesitate to call us.

We are more likely to be able to resolve any issues than the store from where you bought it.

Please have the following information ready to enable our staff to deal with your query quickly:

- Name of the product.
- Model number as shown on underside of the appliance.
- Serial number as shown on underside of the appliance.

**UK Helpline 0844 871 0960**

**Replacement Parts 0844 873 0726**

**Ireland Helpline 1800 409 119**

**WEBSITE**

You may also contact us through our website, or visit the site to browse and purchase appliances, spare parts and accessories from the extensive Morphy Richards range.

**www.morphyrichards.com**

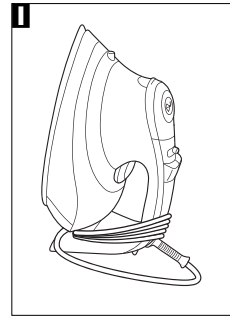

## REGISTERING YOUR TWO YEAR GUARANTEE

Your standard one year guarantee is extended for an additional 12 months when you register the product within 28 days of purchase with Morphy Richards. If you do not register the product with Morphy Richards within 28 days, your product is guaranteed for 1 year. To validate your 2 year guarantee register with us online at [www.morphyrichards.co.uk](http://www.morphyrichards.co.uk)

N.B. Each qualifying product needs to be registered with Morphy Richards individually.

**Please note that the 2 year guarantee is only available in the UK and Ireland.** Please refer to the one year guarantee for more information.

## YOUR ONE YEAR GUARANTEE

It is important to retain the retailer's receipt as proof of purchase. Staple your receipt to this back cover for future reference.

Please quote the following information if the product develops a fault. These numbers can be found on the base of the product.

**Model no.**

**Serial no.**

All Morphy Richards products are individually tested before leaving the factory. In the unlikely event of any appliance proving to be faulty within 28 days of purchase, it should be returned to the place of purchase for it to be replaced.

Morphy Richards products are intended for household use only.

Morphy Richards has a policy of continuous improvement in product quality and design. The company, therefore, reserves the right to change the specification of its models at any time.

If the fault develops after 28 days and within 12 months of original purchase, you should contact the Helpline number quoting Model number and Serial number on the product, or write to Morphy Richards at the address shown.

You may be asked to return a copy of proof of purchase.

Subject to the exclusions set out below (see Exclusions), the faulty appliance will then be repaired or replaced and dispatched usually within 7 working days of receipt.

If, for any reason, this item is replaced during the 1 year guarantee period, the guarantee on the new item will be calculated from original purchase date. Therefore it is vital to retain your original till receipt or invoice to indicate the date of initial purchase.

To qualify for the 1 year guarantee, the appliance must have been used according to the instructions supplied. For example, crumb trays should have been emptied regularly.

## EXCLUSIONS

Morphy Richards shall not be liable to replace or repair the goods under the terms of the guarantee where:

- 1 The fault has been caused or is attributable to accidental use, misuse, negligent use or used contrary to the manufacturer's recommendations or where the fault has been caused by power surges or damage caused in transit.
- 2 The appliance has been used on a voltage supply other than that stamped on the products.

3 Repairs have been attempted by persons other than our service staff (or authorised dealer).

4 The appliance has been used for hire purposes or non domestic use.

5 The appliance is second hand.

6 Morphy Richards are not liable to carry out any type of servicing work, under the guarantee.

7 Plastic filters for all Morphy Richards kettles and coffee makers are not covered by the guarantee.

8 Batteries and damage from leakage are not covered by the guarantee.

• This guarantee does not confer any rights other than those expressly set out above and does not cover any claims for consequential loss or damage. This guarantee is offered as an additional benefit and does not affect your statutory rights as a consumer.



For electrical products sold within the European Community. At the end of the electrical products useful life, it should not be disposed of with household waste.

Please recycle where facilities exist. Check with your Local Authority or retailer for recycling advice in your country.

**morphy richards®**

**The After Sales Division  
Morphy Richards Ltd**  
Mexborough, South Yorkshire,  
England, S64 8AJ

Helpline (office hours)  
UK 0844 871 0960  
Spare Parts 0844 873 0726  
Republic of Ireland 1800 409 119

RN40854 MUK Rev 1 09/10

For details of other Morphy Richards products, plus replacement parts and accessories, please see our website:

[www.morphyrichards.com](http://www.morphyrichards.com)